



## Switchboard Shunts

**FK – 1000 to 2000 AMPS**

**GENERAL INFORMATION:**

Extending measurement of currents beyond available limits of self-contained DC ammeters

**APPLICATIONS:**

Panel meters, Switchboard, solar, rail, or other DC applications

**CONTINUOUS OPERATION**

Recommended that shunts are not run at more than two-thirds (2/3) the rated current under normal conditions as per IEEE standards

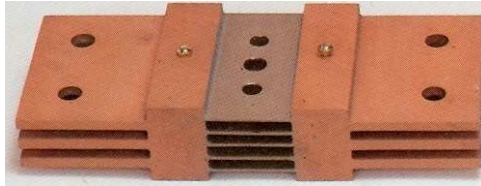

<b>Model</b>	<b>FK</b>
<b>Amperes</b>	1000 - 2000

**MODEL FK – 1000 to 2000 AMPS**

Approximate weight: 0.6 lbs.

**50 mV Series**

CATALOG NUMBER	INPUT (AMPS)	OUTPUT (mV)	ACCURACY
FK-1000-50	1000	50	± 0.25%
FK-1200-50	1200	50	± 0.25%
FK-1500-50	1500	50	± 0.25%
FK-2000-50	2000	50	± 0.25%

**100 mV Series**

CATALOG NUMBER	INPUT (AMPS)	OUTPUT (mV)	ACCURACY
FK-1000-100	1000	100	± 0.25%
FK-1200-100	1200	100	± 0.25%
FK-1500-100	1500	100	± 0.25%
FK-2000-100	2000	100	± 0.25%

Tolerances ± 0.015 in (0.381 mm) for hole diameters.  
 Other tolerances ± 0.030 in (0.762 mm) unless otherwise noted.  
 Dimensions are subjects to change without notice.



# Switchboard Shunts

**FK – 1000 to 2000 AMPS**

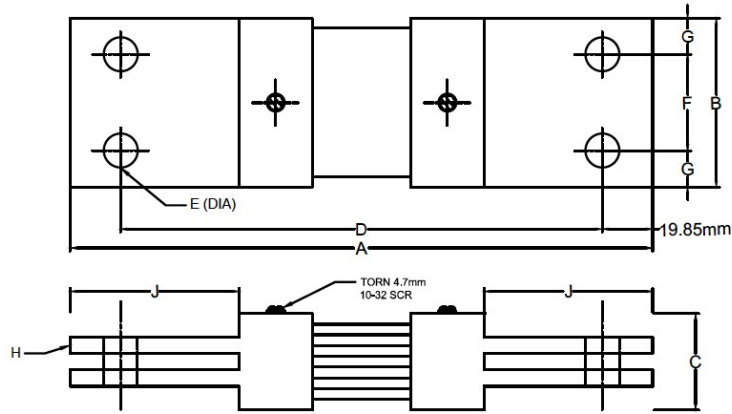

H Number of copper blades at each end.  
6.35 mm (1/4)" thick, 6.35 mm (1/4)" Apart.

### 50mV MODEL TYPE FK 1000 THROUGH 2000 AMPERES

CATALOG No.	AMP	A		B		C		D		E		F		G		H		J	
		mm	in	mm	in	mm	in	mm	in	mm	in	mm	in	mm	in	mm	in	mm	in
FK-1000-50	1000	230.19	9 1/16	66.68	2 5/8	38.1	1 1/2	190.5	7 1/2	13.49	17/32	38.1	1 1/2	14.29	9/16	2		66.8	2 5/8
FK-1200-50	1200	230.19	9 1/16	76.2	3	38.1	1 1/2	190.5	7 1/2	13.49	17/32	38.1	1 1/2	190.5	7 1/2	2		66.8	2 5/8
FK-1500-50	1500	230.19	9 1/16	76.2	3	38.1	1 1/2	190.5	7 1/2	13.49	17/32	38.1	1 1/2	190.5	7 1/2	2		66.8	2 5/8
FK-2000-50	2000	230.19	9 1/16	82.55	3 1/4	38.1	1 1/2	190.5	7 1/2	13.49	17/32	50.8	2	15.88	5/8	3		66.8	2 5/8

### 100mV MODEL TYPE FK 1000 THROUGH 2000 AMPERES

CATALOG No.	AMP	A		B		C		D		E		F		G		H		J	
		mm	in	mm	in	mm	in	mm	in	mm	in	mm	in	mm	in	mm	in	mm	in
FK-1000-100	1000	260.35	10 1/4	66.68	2 5/8	38.1	1 1/2	225.43	8 7/8	13.49	17/32	38.1	1 1/2	14.29	9/16	2		66.8	2 5/8
FK-1200-10	1200	260.35	10 1/4	76.2	3	38.1	1 1/2	225.43	8 7/8	13.49	17/32	38.1	1 1/2	190.5	7 1/2	2		66.8	2 5/8
FK-1500-100	1500	260.35	10 1/4	76.2	3	38.1	1 1/2	225.43	8 7/8	13.49	17/32	38.1	1 1/2	190.5	7 1/2	2		66.8	2 5/8
FK-2000-100	2000	260.35	10 1/4	82.55	3 1/4	50.8	2	225.43	8 7/8	13.49	17/32	50.8	2	15.88	5/8	3		66.8	2 5/8

Tolerances  $\pm 0.015$  in (0.381 mm) for hole diameters.  
Other tolerances  $\pm 0.030$  in (0.762 mm) unless otherwise noted.  
Dimensions are subjects to change without notice.