



Lightweight Shunts

TM (A) - 5 to 150

GENERAL INFORMATION:

Extending measurement of currents beyond available limits of self-contained DC ammeters

APPLICATIONS:

Solar generators Wind power Heavy industry Electroplating Battery chargers Mining

CONTINUOUS OPERATION

Recommended that shunts are not run at more than two-thirds (2/3) the rated current under normal conditions as per IEEE standards



Model	TM (A)
Amperes	5 - 150

MODEL TM – 5 to 150 AMPS
Approximate weight: 0.6 lbs.

50 mV Series

CATALOG NUMBER	INPUT (AMPS)	OUTPUT (mV)	ACCURACY
TM-5-50	5	50	± 0.25%
TM-10-50	10	50	± 0.25%
TM-15-50	15	50	± 0.25%
TM-20-50	20	50	± 0.25%
TM-30-50	30	50	± 0.25%
TM-50-50	50	50	± 0.25%
TM-75-50	75	50	± 0.25%
TM-80-50	80	50	± 0.25%
TM-85-50	85	50	± 0.25%
TM-100-50	100	50	± 0.25%
TM-150-50	150	50	± 0.25%

100 mV Series

CATALOG NUMBER	INPUT (AMPS)	OUTPUT (mV)	ACCURACY
TM-5-100	5	100	± 0.25%
TM-10-100	10	100	± 0.25%
TM-15-100	15	100	± 0.25%
TM-20-100	20	100	± 0.25%
TM-30-100	30	100	± 0.25%
TM-50-100	50	100	± 0.25%
TM-75-100	75	100	± 0.25%
TM-80-100	80	100	± 0.25%
TM-85-100	85	100	± 0.25%
TM-100-100	100	100	± 0.25%
TM-150-100	150	100	± 0.25%

Tolerances ± 0.015 in (0.381 mm) for hole diameters.
Other tolerances ± 0.030 in (0.762 mm) unless otherwise noted.
Dimensions are subjects to change without notice.

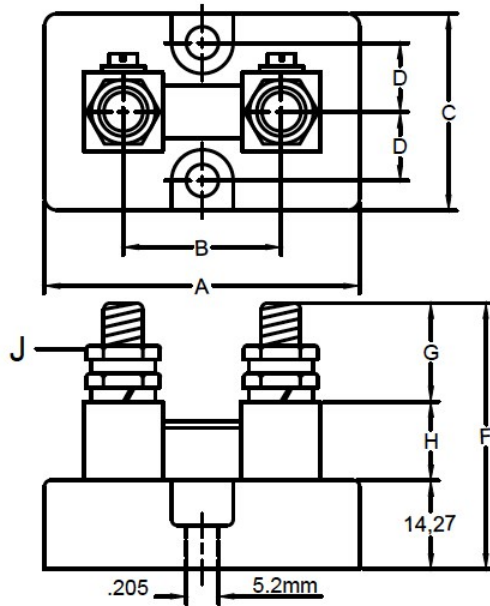

50mV MODEL TYPE TM 5 THROUGH 150 AMPERES

I CATALOG# No.	AMP	A		B		C		D		F		H		J	
		mm	in	mm	in	mm	in	mm	in	mm	in	mm	in	mm	in
TM-5-50	5	50.8	2	25.4	1	31.75	1 1/4	11.1	.437	42.88	1.688	12.7	1/2	6.35-28	1/4-28
TM-10-50	10	50.8	2	25.4	1	31.75	1 1/4	11.1	.437	42.88	1.688	12.7	1/2	6.35-28	1/4-28
TM-15-50	15	50.8	2	25.4	1	31.75	1 1/4	11.1	.437	42.88	1.688	12.7	1/2	6.35-28	1/4-28
TM-20-50	20	50.8	2	25.4	1	31.75	1 1/4	11.1	.437	42.88	1.688	12.7	1/2	6.35-28	1/4-28
TM-30-50	30	50.8	2	25.4	1	31.75	1 1/4	11.1	.437	42.88	1.688	12.7	1/2	6.35-28	1/4-28
TM-50-50	50	50.8	2	25.4	1	31.75	1 1/4	11.1	.437	42.88	1.688	12.7	1/2	6.35-28	1/4-28
TM-75-50	75	50.8	2	25.4	1	31.75	1 1/4	11.1	.437	42.88	1.688	12.7	1/2	6.35-28	1/4-28
TM-80-50	80	50.8	2	25.4	1	31.75	1 1/4	11.1	.437	42.88	1.688	12.7	1/2	6.35-28	1/4-28
TM-85-50	85	50.8	2	25.4	1	31.75	1 1/4	11.1	.437	42.88	1.688	12.7	1/2	6.35-28	1/4-28
TM-100-50	100	50.8	2	25.4	1	31.75	1 1/4	11.1	.437	42.88	1.688	12.7	1/2	6.35-28	1/4-28
TM-150-50	150	50.8	2	25.4	1	31.75	1 1/4	11.1	.437	42.88	1.688	12.7	1/2	6.35-28	1/4-28

100mV MODEL TYPE TM 5 THROUGH 150 AMPERES

I CATALOG# No.	AMP	A		B		C		D		F		H		J	
		mm	in	mm	in	mm	in	mm	in	mm	in	mm	in	mm	in
TM-5-100	5	50.8	2	25.4	1	31.75	1 1/4	11.1	.437	42.88	1.688	12.7	1/2	6.35-28	1/4-28
TM-10-100	10	50.8	2	25.4	1	31.75	1 1/4	11.1	.437	42.88	1.688	12.7	1/2	6.35-28	1/4-28
TM-15-100	15	50.8	2	25.4	1	31.75	1 1/4	11.1	.437	42.88	1.688	12.7	1/2	6.35-28	1/4-28
TM-20-100	20	50.8	2	25.4	1	31.75	1 1/4	11.1	.437	42.88	1.688	12.7	1/2	6.35-28	1/4-28
TM-30-100	30	50.8	2	25.4	1	31.75	1 1/4	11.1	.437	42.88	1.688	12.7	1/2	6.35-28	1/4-28
TM-50-100	50	50.8	2	25.4	1	31.75	1 1/4	11.1	.437	42.88	1.688	12.7	1/2	6.35-28	1/4-28
TM-75-100	75	50.8	2	25.4	1	31.75	1 1/4	11.1	.437	42.88	1.688	12.7	1/2	6.35-28	1/4-28
TM-80-100	80	50.8	2	25.4	1	31.75	1 1/4	11.1	.437	42.88	1.688	12.7	1/2	6.35-28	1/4-28
TM-85-100	85	50.8	2	25.4	1	31.75	1 1/4	11.1	.437	42.88	1.688	12.7	1/2	6.35-28	1/4-28
TM-100-100	100	50.8	2	25.4	1	31.75	1 1/4	11.1	.437	42.88	1.688	12.7	1/2	6.35-28	1/4-28
TM-150-100	150	50.8	2	25.4	1	31.75	1 1/4	11.1	.437	42.88	1.688	12.7	1/2	6.35-28	1/4-28

Tolerances ± 0.015 in (0.381 mm) for hole diameters.

Other tolerances ± 0.030 in (0.762 mm) unless otherwise noted.

Dimensions are subjects to change without notice.