



Current Transformer

Model 2

APPLICATION:

Generally for Ammeter use only

FREQUENCY:

50-400 Hz.

INSULATION LEVEL:

600 Volts. 10 kV BIL. full wave

WINDOW:

1.00", 1.05", 1.13"

APPROXIMATE WEIGHT:

0.5 lbs.

CONNECTIONS:

-Flexible Leads are UL 1015 105°C, CSA approved #16 AWG, 24" long

-Non-standard length to be specified

-Terminals are brass studs No. 8-32 UNC with one flat washer, lockwasher, and regular nut

-SHT and SFT case styles also available as SHL or SFL with Leads

-Mounting bracket for Model 2SHT part 0221B00839



2SHT



2SFT



2RL



2DRL

CERTIFICATIONS:



237637

Model	2SHT	2SFT	2RL	2DRL
Window Size	1.13	1.13	1.05	1.00
Width	2.40	2.40	2.46	2.42
Height	2.71	2.68	2.46	2.42
Depth	0.95	2.00	1.05	1.75

MODEL 2

Window Diameter 1.00", 1.05", 1.13"

Approximate weight: 0.5 lbs.

CATALOG NUMBER	CURRENT RATIO	MODELS 2SFT, 2SHT, 2RL		MODEL 2DRL	
		ACCURACY AT 60 HZ	BURDEN VA AT 60 HZ	ACCURACY AT 60 HZ	BURDEN VA AT 60 HZ
2**-500	50:5	± 4%	1	± 2%	1.5
2**-600	60:5	± 3%	2	± 2%	2
2**-750	75:5	± 3%	2	± 2%	3
2**-800	80:5	± 2%	2	± 2%	4
2**-101	100:5	± 1%	2	± 1%	5
2**-121	120:5	± 1%	2.5	± 1%	5
2**-1250	125:5	± 1%	2.5	± 1%	5
2**-151	150:5	± 1%	4	± 1%	8
2**-181	180:5	± 1%	4	± 1%	10
2**-201	200:5	± 1%	4	± 1%	10
2**-251	250:5	± 1%	6	± 1%	12.5
2**301	300:5	± 1%	8	± 1%	15

NOTE: When ordering, Prefix Cat. No. With model designation required, i.e. 2SFT-301, 2RL-301, or 2SHT-301 or 2DRL-301

Products are manufactured in a plant whose quality management system is certified / registered as being in conformity with ISO 9001

2SHT

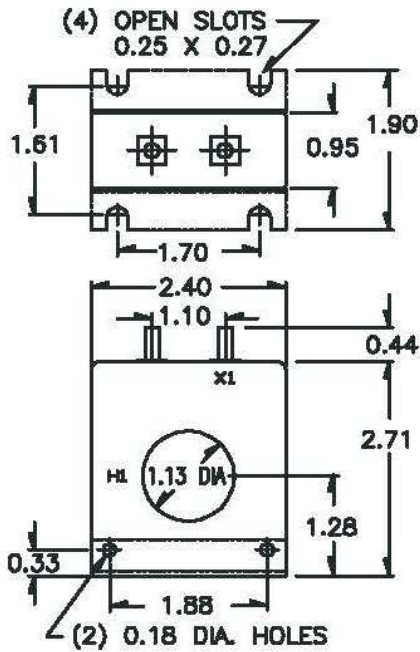

2SFT

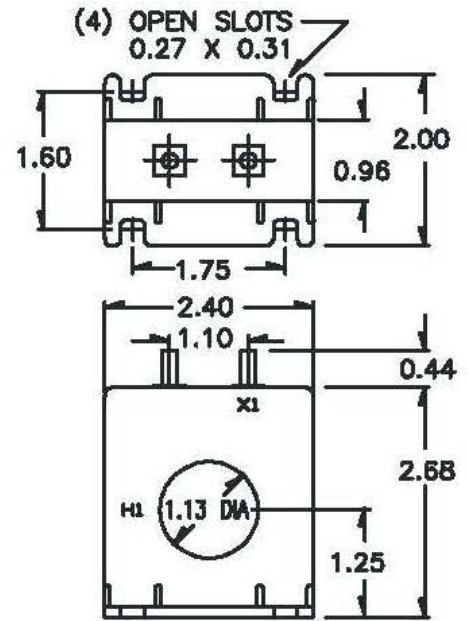

2RL

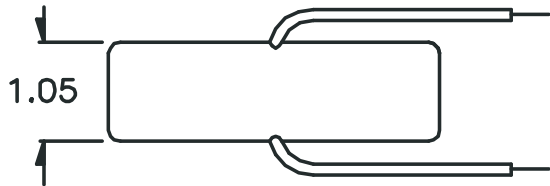

2DRL

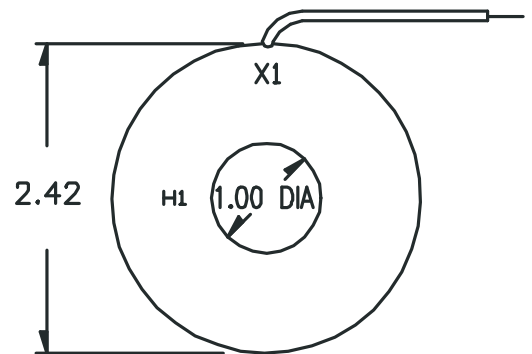
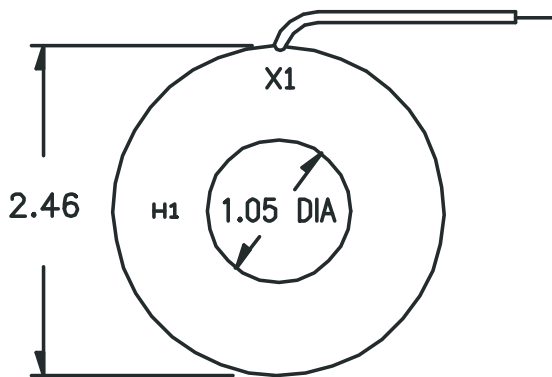
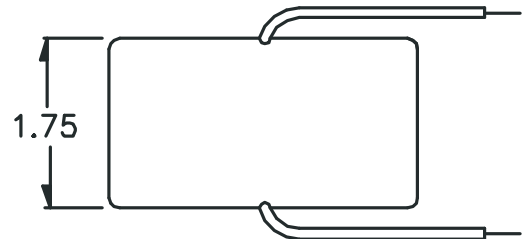

Products are manufactured in a plant whose quality management system is certified / registered as being in conformity with ISO 9001