



Switchboard Shunts

FI - 300 to 1200 AMPS

GENERAL INFORMATION:

Extending measurement of currents beyond available limits of self-contained DC ammeters

APPLICATIONS:

Panel meters, Switchboard, solar, rail, or other DC applications

CONTINUOUS OPERATION

Recommended that shunts are not run at more than two-thirds (2/3) the rated current under normal conditions as per IEEE standards



Model	FI
Amperes	300 - 1200

MODEL FI – 300 to 1200 AMPS

Approximate weight: 0.6 lbs.

50 mV Series

CATALOG NUMBER	INPUT (AMPS)	OUTPUT (mV)	ACCURACY
FI-300-50	300	50	± 0.25%
FI-400-50	400	50	± 0.25%
FI-500-50	500	50	± 0.25%
FI-600-50	600	50	± 0.25%
FI-750-50	750	50	± 0.25%
FI-800-50	800	50	± 0.25%
FI-1000-50	1000	50	± 0.25%
FI-1200-50	1200	50	± 0.25%

100 mV Series

CATALOG NUMBER	INPUT (AMPS)	OUTPUT (mV)	ACCURACY
FI-300-100	300	100	± 0.25%
FI-400-100	400	100	± 0.25%
FI-500-100	500	100	± 0.25%
FI-600-100	600	100	± 0.25%
FI-750-100	750	100	± 0.25%
FI-800-100	800	100	± 0.25%
FI-1000-100	1000	100	± 0.25%
FI-1200-100	1200	100	± 0.25%

Tolerances ± 0.015 in (0.381 mm) for hole diameters.
 Other tolerances ± 0.030 in (0.762 mm) unless otherwise noted.
 Dimensions are subjects to change without notice.

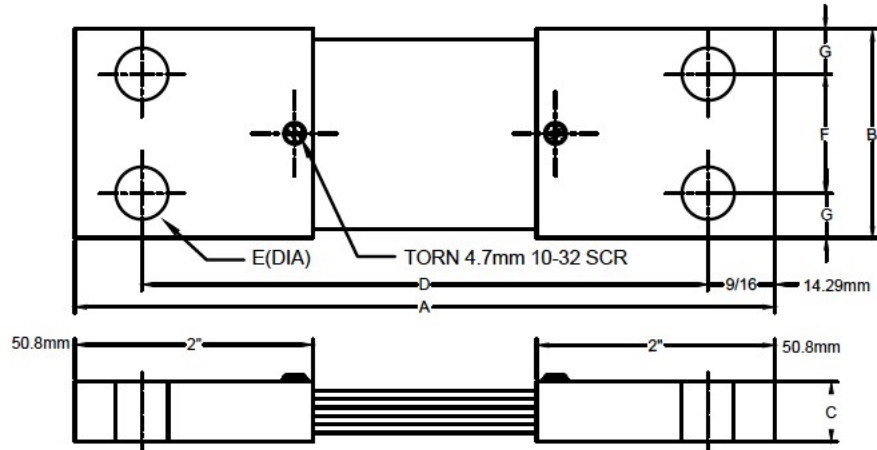

50mV MODEL TYPE FI 300 THROUGH 1200 AMPERES

CATALOG No.	AMP	A		B		C		D		E		F		G	
		mm	in	mm	in	mm	in	mm	in	mm	in	mm	in	mm	in
FI-300-50	300	149.23	5 7/8	44.45	1 3/4	12.7	1/2	120.65	4 3/4	11.12	7/16	25.4	1	9.53	3/8
FI-400-50	400	149.23	5 7/8	50.8	2	19.05	3/4	120.65	4 3/4	11.12	7/16	31.75	1 1/4	9.53	3/8
FI-500-50	500	149.23	5 7/8	50.8	2	19.05	3/4	120.65	4 3/4	11.12	7/16	31.75	1 1/4	9.53	3/8
FI-600-50	600	149.23	5 7/8	50.8	2	19.05	3/4	120.65	4 3/4	11.12	7/16	31.75	1 1/4	9.53	3/8
FI-750-50	750	149.23	5 7/8	57.15	2 1/4	19.05	3/4	120.65	4 3/4	11.12	7/16	38.1	1 1/2	9.53	3/8
FI-800-50	800	149.23	5 7/8	60.33	2 3/8	19.05	3/4	120.65	4 3/4	11.12	7/16	38.1	1 1/2	11.12	7/16
FI-1000-50	1000	149.23	5 7/8	63.5	2 1/2	25.4	1	120.65	4 3/4	11.12	7/16	38.1	1 1/2	12.7	1/2
FI1200-50	1200	149.23	5 7/8	73.03	2 7/8	25.4	1	120.65	4 3/4	11.12	7/16	38.1	1 1/2	17.46	11/16

100mV MODEL TYPE FI 300 THROUGH 1200 AMPERES

CATALOG No.	AMP	A		B		C		D		E		F		G	
		mm	in	mm	in	mm	in	mm	in	mm	in	mm	in	mm	in
FI-300-100	300	177.8	7	44.45	1 3/4	12.7	1/2	149.23	5 7/8	11.12	7/16	25.4	1	9.53	3/8
FI-400-100	400	177.8	7	50.8	2	19.05	3/4	149.23	5 7/8	11.12	7/16	31.75	1 1/4	9.53	3/8
FI-500-100	500	177.8	7	50.8	2	19.05	3/4	149.23	5 7/8	11.12	7/16	31.75	1 1/4	9.53	3/8
FI-600-100	600	177.8	7	50.8	2	19.05	3/4	149.23	5 7/8	11.12	7/16	31.75	1 1/4	9.53	3/8
FI-750-100	750	177.8	7	57.15	2 1/4	19.05	3/4	149.23	5 7/8	11.12	7/16	38.1	1 1/2	9.53	3/8
FI-800-100	800	177.8	7	60.33	2 3/8	19.05	3/4	149.23	5 7/8	11.12	7/16	38.1	1 1/2	11.12	7/16
FI-1000-100	1000	177.8	7	63.5	2 1/2	25.4	1	149.23	5 7/8	11.12	7/16	38.1	1 1/2	12.7	1/2
F-1200-100	1200	177.8	7	73.03	2 7/8	25.4	1	149.23	5 7/8	11.12	7/16	38.1	1 1/2	17.46	11/16

Tolerances ± 0.015 in (0.381 mm) for hole diameters.

Other tolerances ± 0.030 in (0.762 mm) unless otherwise noted.

Dimensions are subjects to change without notice.